

# GTX600 T-LOCK BASE INSTRUCTIONS

## Items Needed for Assembling GTX600 T-LOCK BASE:

### T-Lock Base- #TLOCKBASE

Purchased separately or as part of #TLOCKKIT.

### GTX600 XL Pin - #GTX600XLLARGEPIN

One [1] pin to enable T-Lock compatibility with GTX600 printers and all prior GT models.

## Instructions for assembling T-LOCK BASE:

Below are instructions for removing the existing T-Lock Pin and installing the GTX600 XL Pin.



### Step 1:

A small screwdriver and 3mm allen key is required for assembly.



### Step 2:

Locate the screw that holds the center pin in place.

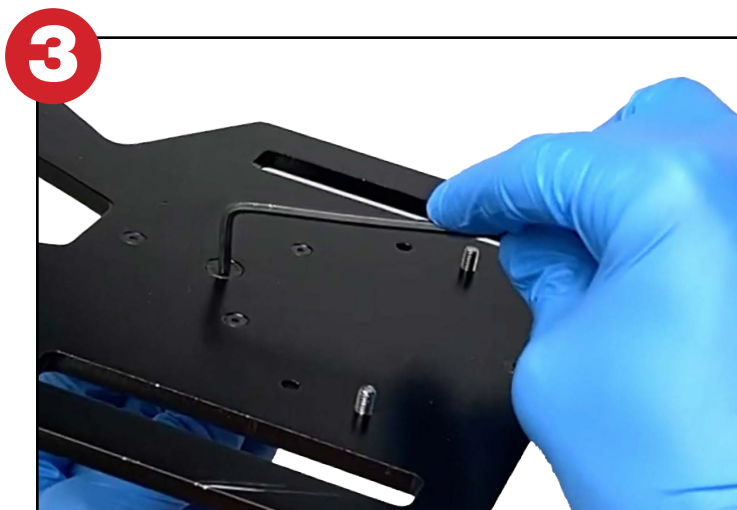

### Step 3:

Insert the allen key into the screw and hold the key in place.

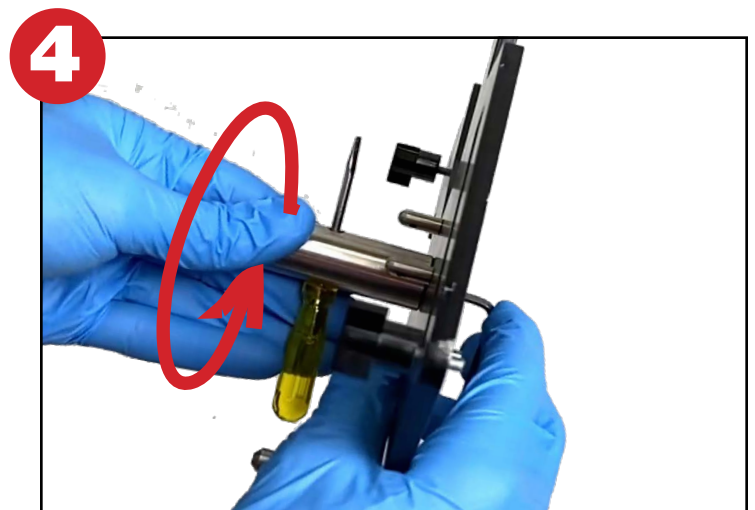

### Step 4:

Slide a small screwdriver through the hole in the center pin. Unscrew the pin by holding the screwdriver and rotating the pin in a counterclockwise motion.



**Step 5:**  
Remove the pin from the assembly. Keep the allen key and screw.



**Step 6:**  
Grab the GTX600 XL Pin, indicated in the image above as the larger pin of the two.



**Step 7:**  
Note the position of the flat side of the GTX600 XL Pin. This must be positioned to the right side of the T-Lock Base.

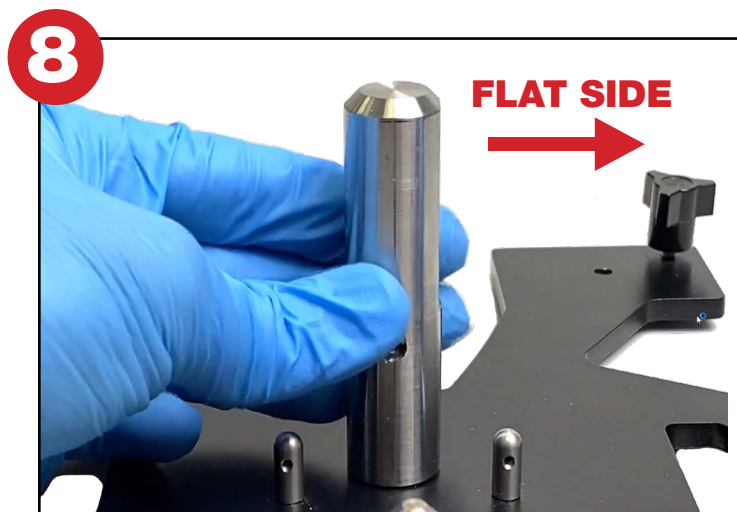

**Step 8:**  
Align the pin to the T-Lock Base, with the flat side oriented to the right. Hand-tighten the pin.

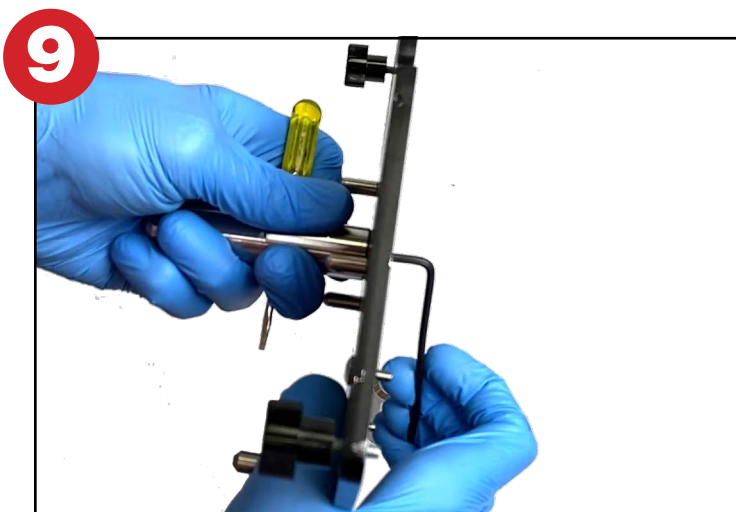

**Step 9:**  
Use the screw, allen key, and screwdriver to adjust the position of the pin and tighten the assembly.

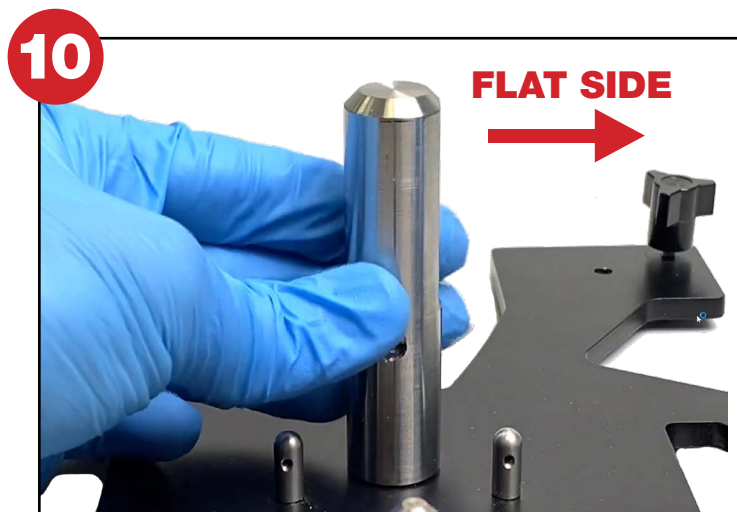

**Step 10:**  
After tightening, make sure the flat side of the pin is oriented towards the right side of the T-Lock. Assembly completed.