

QUICK USER GUIDE



An operations guide for GT-3 Series Printers.
**Refer to Instruction Manual for detailed
information on each section of this guide.**





> Temperature & Humidity Requirements :

TEMPERATURE		HUMIDITY	
	MIN		MIN
	64°		35
	MAX		MAX
	86°		85

OVERVIEW OF GT3 MAINTENANCE



There are several maintenance procedures that **must be performed** on a daily, weekly, or prompted basis to help keep your printer performing **properly**. This guide will list the maintenance items that must be performed.

Please see the individual technical guide for each specific maintenance procedure for step by step instructions.

FIRST BASIC STEPS



> HOW TO DO A NOZZLE TEST ?

! TO BE DONE EVERY WORKING DAY



Always place the **Platen** at level **A**

Menu > **Test Print** > **Nozzle Check CMYK** > **OK** to check colors on white paper sheet

Menu > **Test Print** > **Nozzle Check White** > **OK** to check whites on transparent or black sheet

If not all the nozzles are firing, start a **Head Cleaning**

> HOW TO DO A PRINT HEAD CLEANING ?



Only a few nozzles missing, then **Head Cleaning** > **Normal Cleaning** ... and select **PH + OK**

If more then 10 nozzles, perform **Head Cleaning** > **Powerful Cleaning** ... and select **PH + OK**

Perform a new Nozzle Test to check the result and redo if not all nozzles are firing

HOW TO CREATE A LOG FILE ?



Switch on the printer and insert a **USB stick**.

Go to the menu: **Maintenance** > **Log copy to USB**



> Shaking White Ink

The White ink contains **titanium dioxide** which helps provide vibrancy.

This will separate after being stationary for more than **eighteen hours**.

Dull prints will result if the ink is **not agitated before use**. Put the white ink cartridge upside down and shake it side to side and tip end over end for **1min 30sec**.

+ > No matter if you will have to do the **WTF** or **WA**, you **must** **SWI** **BEFORE !**

> White Tube Flush



If the printer has **NOT** printed with **white** ink a **minimum of 15 T-shirts** the day before...

OR



If the printer has **NOT** printed with **white** ink within the last **eighteen hours**

> Then the **WTF** **must be performed** after the **SWI**

> White Agitation

Firmware version 3.00 or higher



If the printer has printed with **white** ink a **minimum of 15 T-shirts** the day before...

OR



If the printer has printed with **white** ink within the last **eighteen hours**...

> Then the **WA** **could be performed instead of** **WTF** directly after the **SWI**

> TIP

+ **NZC** & **PHC**

After performing the daily maintenance on the white ink, a **nozzle check** should be **printed** to verify the print **quality** !



> WEEKLY MAINTENANCE PROCEDURE

 White ink requires **weekly maintenance**. The white ink tubes need a **weekly cleaning**.

The **LCD Display** will prompt you when the White Tube Cleaning should be performed. The prompt will appear **seven days** after the completion of the **previous White Tube Cleaning**.

> White Tube Cleaning

 TO BE DONE **EVERY WEEK**

Menu > Maintenance > White Tube Cleaning > All Whites > OK and follow instructions on the display

This action washes away the pigments inside the **Tubes** and **Print Heads** but also cleans the **Tubes** of the **Maintenance Station**.

It is very important for the long life of your printer!

When you execute this menu **all-in-one time**, you can **retrieve** the White Ink before Tube Cleaning. It takes time but you can save the cost of the lost ink.

If you select the Tubes separately one by one then the White Ink will **not** be retrieved.

Directly after **WTC**, perform a **Load White** with freshly shaken White ink :

Menu > Maintenance > Load White > All Whites > OK and follow instructions on the display



After performing the White ink loading, a **nozzle check** should be **printed**.



Please note that **1 week** after the **WTC** you will be prompted by the display to perform a new **WTC** automatically.

> MAINTENANCE CARTRIDGES WHITE

Because of the filtering system, this cartridge is a **consumable** part !

Use a new one after you finish **4 bottles** of Maintenance Solution [5Kg/5L of GC-50S5K] or **after one year** passes.

Use the label to **checkmark** the number of bottles used or/and the starting date.

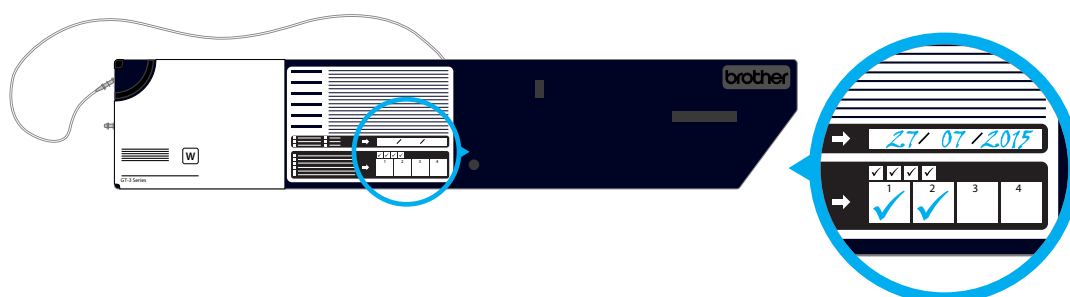



> ADDITIONAL MAINTENANCE PROCEDURE



Visual inspection is important to keep your printer up and running.

Verify all the moving parts of the machine and also check for leakage of ink.

After you have done the **WTC**, take the opportunity to **clean** the **rubber Wiper Blades** to avoid the white ink to dry and stay on the Wiper. It will prevent dry particules of ink to block the nozzles during the next cleaning.

Also **clean all the caps** of the maintenance station (specially the rectangle lip) to remove again dry ink but also some fluff and lint of the T-shirts. They will allow the air to pass through the capping station and reduce the good suction of the pump.

> WIPER BLADES CLEANING :

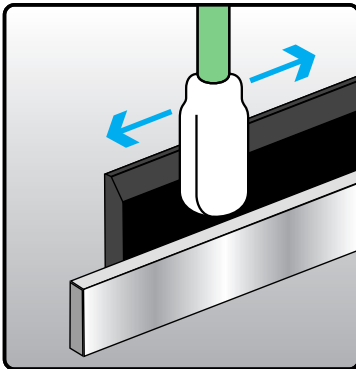

The wiper **cleans** the underside of the **print heads** to allow the **nozzles** to fire properly. The wiper is cleaned by passing across the **wiper cleaner**.

Once this cleaner is dirty or over saturated, the wiper edge can **no longer be cleaned** and therefore no longer clean the nozzle plates.

Apply **cleaning solution** to a swab and wipe across the **front** and **backside** of the 2 wiper **rubber blades**.

Check the wiper edge for any **tear** or separation from the metal base. If any exists, the wiper sub-assembly must be replaced by a new one.



SPARE PARTS NUMBER:

SB3635001

> RUBBER CAPS CLEANING :



Once the wipers are clean, the **rubbers caps** must be cleaned with the **swabs** as well. The **rims** of the cap rubbers press against the bottom of the print head's CLP, to form a **seal** so air cannot dry the heads. If the rims of the caps have debris, dried or excessive ink, the ink will back away from the membrane and nozzles will **misfire**.

If this continues over time, the **print head** will dry and eventually become **defective**.

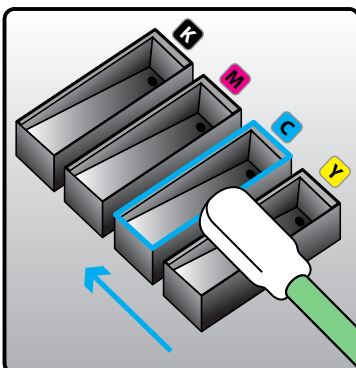

Moisten a swab as done for the wiper blade cleaning, and **swab the edges** and the **inside** of the **rubber caps**.

Use **one side** of a swab **per cap** so you do not **contaminate** one color to another, from **Y** to **C** to **M** to **K**.

Clean **White** caps also !

Once all of the caps have been cleaned, **insert** the **new wiper cleaners** in place. The wiper blades should be in the **center**, between the two sets of 4 rubber caps.

Power on the printer. The printer will boot up as normal except it will **drain each cap**, one at a time, before it moves the carriage.

STANDARD MAINTENANCE SCHEDULE



> WHITE Maintenance Standard Procedure for GT3 Series

Week	Mon	Tue	Wed	Thu	Fri	Sat	Sun
361 381 W	1 WTC ⊕ LW	WTF	WTF	WTF	WTF	-	-
2	WTC ⊕ LW	WTF	WTF	WTF	WTF	-	-
3	WTC ⊕ LW	WTF	WTF	WTF	WTF	-	-
4	WTC ⊕ LW	WTF	WTF	WTF	WTF	-	-

White Tube Cleaning

Load White

White Tube Flush



Shaking White Ink

Everyday before operating !



Cleaning & Greasing

MAINTENANCE with WHITE AGITATION SCHEDULE



> ONLY FOR USERS PRINTING A **MINIMUM** OF 15 PRINTS WITH WHITE INK ON BLACK OR DARK T-SHIRTS A DAY !!!



> 5 working days a week example

Min. 15 white prints a day !

Week	Mon	Tue	Wed	Thu	Fri	Sat	Sun
361 381 W	1 WTC ⊕ LW	WA	WA	WA	WA	-	-
2	WTC ⊕ LW	WA	WA	WA	WA	-	-
3	WTC ⊕ LW	WA	WA	WA	WA	-	-
4	WTC ⊕ LW	WA	WA	WA	WA	-	-



> ADVANCED MAINTENANCE PROCEDURE

Advanced Maintenance has to be performed on top of the **Daily & Weekly** Maintenance. The purpose is to keep the printer in the best status for printing without problems. This is an “as needed” cleaning based upon a visual inspection of debris in the printer.

We recommend you do the **cleaning** and **greasing of the CR shaft, cleaning CR rail** and a good **visual inspection** of the printer.



CARRIAGE SHAFT CLEANING & GREASING

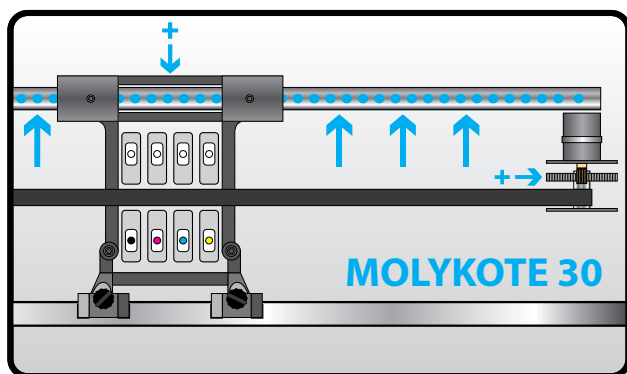

Pour denatured alcohol on a **cloth** and **clean the carriage shaft and bearing pack thoroughly**.

When clean, coat the shaft with **Molykote 30** white grease.

*Don't forget to grease **between** the 2 bearings (Liner Bush 16) in the middle of the carriage.*

Add also a little bit of **Molykote 30 grease** at the bronze **sprocket** of the **CR Motor**.



SPARE PARTS NUMBER:

S58541000

Refer to the [Advanced Maintenance Procedure PDF](#) instructional for detailed instructions



CARRIAGE RAIL CLEANING

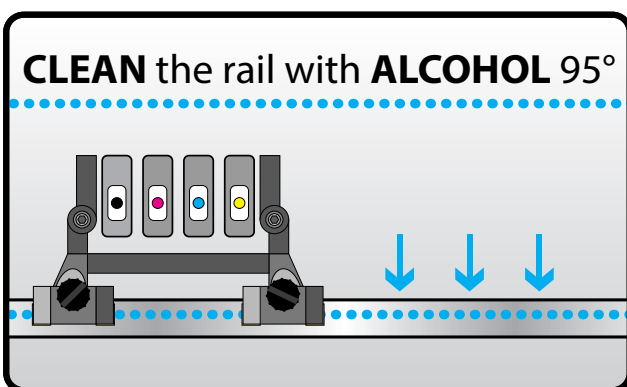

Unscrew the knob on the felt supports and remove them.

Pour denatured alcohol on a **cloth** and **clean the rail thoroughly**.

Remove and **replace the felts** on the bottom of the felt supports in accordance with the “**Maintenance Parts Exchange**”.

Reattach both felt supports and tighten the knob screw.



*After these tasks have been completed perform a **CR Speed Adjustment**.*



> MAINTENANCE PARTS EXCHANGE PROCEDURE :

The 2 **wiper cleaners**, the **fan filter**, the **flushing tray sponge** and **felt pads**, and the **carriage felt pads** need to be replaced in the **MPE** procedure.



The prompt to “**Exchange Maintenance Parts**” will occur after **EIGHTY** head cleanings (normal, powerful, or auto).

Normally after this amount of cleanings, the wiper cleaner will be **saturated** to the point where the wiper can **no longer be cleaned**. When this happens, the nozzle plate will not be cleared and the **nozzles** may be **blocked** or the **firing** may be **misdirected**.

Menu > Maintenance > Maintenance Parts Exchange > OK *follow instructions and turn off printer*



*It is important that you **use this menu** and not another one to replace **MPE** parts because it will **reset** the internal counter to **zero**!*

> Cleaning and Replacing Consumables on the GT3

Display Message :	ACTION to perform :
Flushing Plate Sponge Exchange	REPLACE THE FLUSHING SPONGE & FLUSHING FELT
Roller Felt Exchange	REPLACE THE ROLLER FELT & FAN FILTER
Wiper Cleaner Exchange	<div>CLEAN RUBBER CAPS & WIPER BLADES <i>[to be done every weeks anyway]</i></div> <div>⊕ REPLACE THE WIPER CLEANER</div>

brother

> FLUSHING TRAY FELT & SPONGE REPLACEMENT :

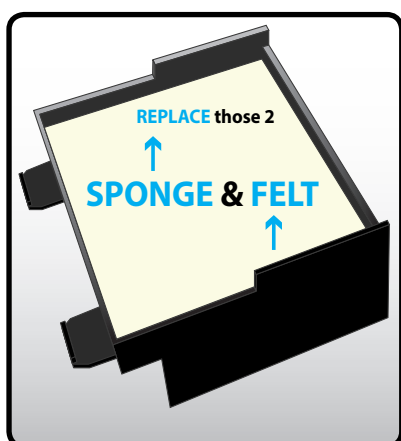

Insert the **felt** into the **flushing plate**.

Place the **sponge** on **top** of the felt.

Install back the assembled flushing plate into the machine.

Check that the **flushing plate** is well inserted and sitting in a **horizontal position** to **avoid touching** the **PH's** in movement!



SPARE PARTS NUMBER:

SB 3004001



SPARE PARTS NUMBER:

SB 3005001

> CARRIAGE FELTS REPLACEMENT [now Roller Felts] :

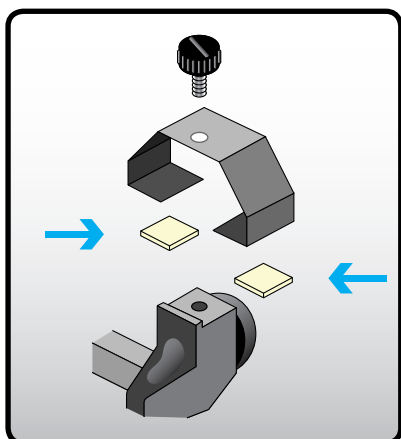

The **Carriage** contains **2 brackets** on the front edge that hold **4 felt pads** onto Velcro inserts. The carriage assembly has **2 wheels** that ride along the front rail. The pads keep the rail **clean** to help allow the carriage move unrestricted and smooth.

*Be carefull **not to bend** the 2 brackets, it may end up with **errors** (i.e. 6107. 6108) and also, **do NOT** put **oil** on the **felts** !*

+ SPARE PARTS NUMBER: **SB 2652101**

> WIPER CLEANER REPLACEMENT :

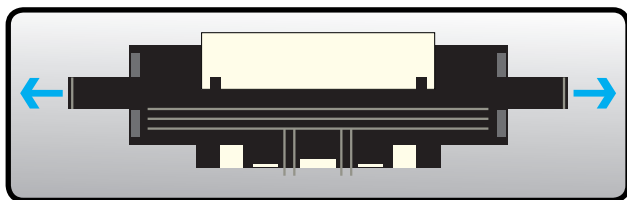

The **Wiper Cleaner** needs to be replaced **regularly** according to **MPE** or visual inspection.

***Clean the Print Head Caps and Wiper Blade before** replacing the Wiper Cleaner !*

+ SPARE PARTS NUMBER: **SB3101101**

> FAN FILTER REPLACEMENT :

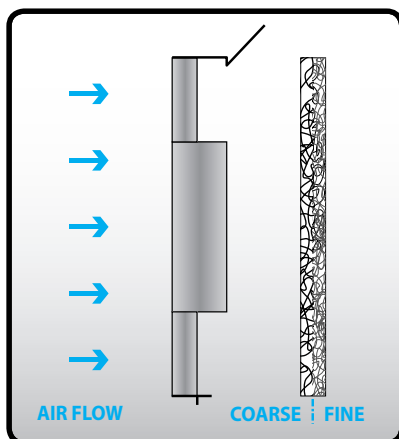

The fan filter collects the mist from the print head spray from the exhaust provided by the fan.

> Remember to place the new filter with the "**Coarse**" side inserted into the bracket.

> The air flow should enter the rougher side.

+ SPARE PARTS NUMBER: **SB3018001**

HOW TO CLEAN THE PRINT HEAD NOZZLES ?



Go to the menu: **Maintenance** > **Nozzle Cleaning** *follow instructions and turn off printer*

- 1 With **Cleaning sticks** and cleaning fluid...
> *Clean the outside of the nozzle metal plate (Green area = CLP)*
- 2 With **Clean Applicator** sticks and cleaning fluid...
> *Clean the surface of the small inner plate with nozzles, only in **one** direction without pressure! Hold the stick by the end!*

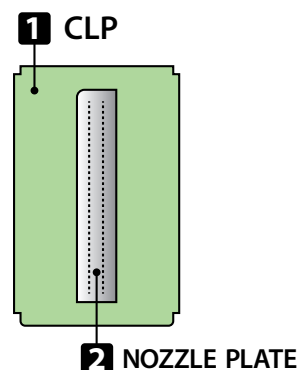

HOW TO CLEAN THE ENCODER STRIP?



Menu > **Maintenance** > **CR Encoder Strip Cleaning** > **OK**

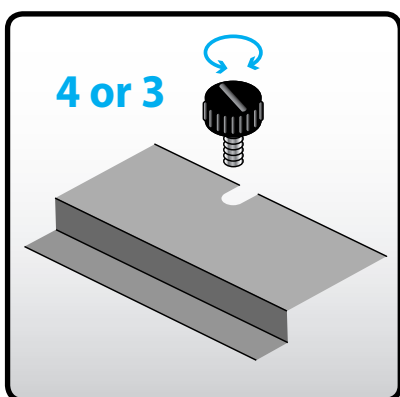

Loosen the four (or three, depending of model) black thumb **screws** (do not remove them completely) of the encoder cover, and remove the cover.

Slide the carriage to the **right side** of the machine.

Take the **encoder cleaning tool**, and apply denatured **alcohol** (95% or higher) to the **felt** portion.

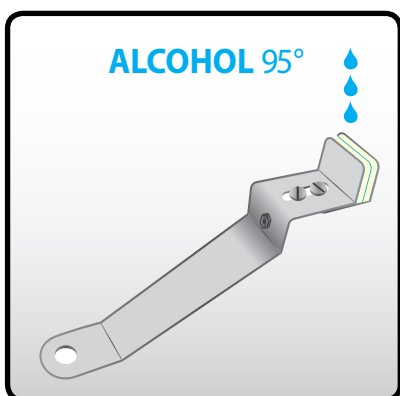

Gently slide the tool across the **encoder strip**, remembering to move the carriage to get the other side of the strip.

Once done 2 or 3 times, remove the encoder tool **being very careful** not to damage the strip.

Attach the **cover back** and tighten the 3 or 4 thumb **screws**.

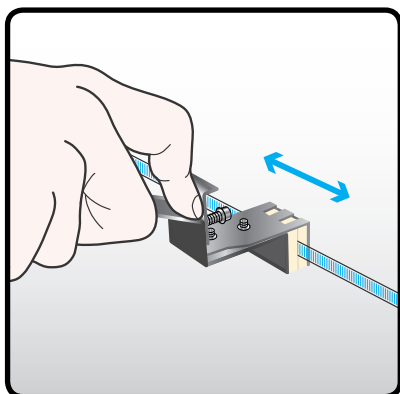

Turn the **machine on**.



After **cleaning** the **Encoder Strip**, perform a **CR Speed Adjustment** on the machine !



INK STORAGE RECOMMENDATIONS

> Please keep in mind when **storing** the inks:

TEMPERATURE

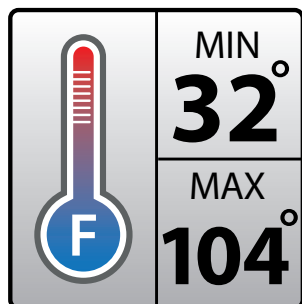

SUNLIGHT



NEW SUPPLY MAINTENANCE KITS AVAILABLE FOR GT3

> FULL MAINTENANCE KIT :

2 x	Wiper Cleaner	SB3101101	4 x	CR Felts	SB2652101
10 x	Clean Stick	SB4000098	2 x	Gloves	---
1 x	Flushing Sponge	SB3004001	10 x	Clean Applicator	SB4000099
1 x	Flushing Felt	SB3005001	1 x	Wash Liquid	SB5679601
1 x	Fan Filter	SB3018001			



SPARE PARTS NUMBER: **SB5677601**

> FILTER FELT KIT :

10 x	Clean Stick	SB4000098	3 x	Fan Filter	SB3018001
3 x	Flushing Sponge	SB3004001	12 x	CR Felt	SB2652101
3 x	Flushing Felt	SB3005001			



SPARE PARTS NUMBER: **SB5678001**



MAINTENANCE PARTS INCLUDED IN CARTRIDGES

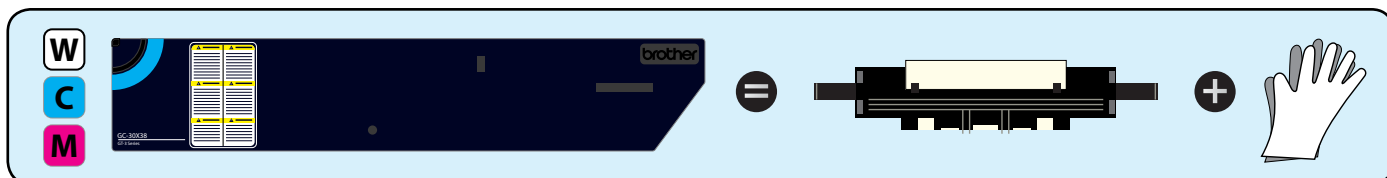

With each **White, Cyan & Magenta** cartridge, you will receive a **Wiper Cleaner** and a pair of plastic **gloves**.



> CLEANING STICKS :



50 x **Clean Stick** for Caps and CLP plate cleaning (*short rectangular model*)

+ SPARE PARTS NUMBER: **SA5784001**



50 x **Clean Applicator** for Nozzle plate cleaning (*long cylindrical model*)

+ SPARE PARTS NUMBER: **SA5888001**

> WASH LIQUID :

1 x 50cc **Wash Liquid** for cleaning Caps, Wiper blade, CLP plate and Nozzles

+ SPARE PARTS NUMBER: **SB5679601**

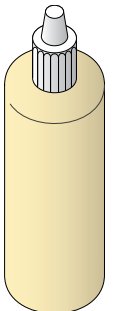

> WIPER ASSY :

1 x **Wiper Assy** for cleaning the surface of the Print Heads

+ SPARE PARTS NUMBER: **SB3635001**



> CAP FELT :

When needed, you can replace the **Cap Felt** sitting in between the two sets of four caps. Just **lift** it and place a new one instead.

+ SPARE PARTS NUMBER: **SB 3006001**

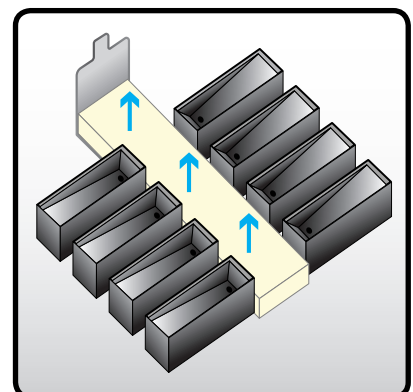

> CAPPING CARTRIDGE WHITE:



According to the Instruction Manual, this **Capping Cartridge White** should be placed in the machine after **WTC** for **long term storage** [i.e. *Holidays*].



SPARE PARTS NUMBER: **SB3047201**

> MAINTENANCE CARTRIDGE for CMYK :

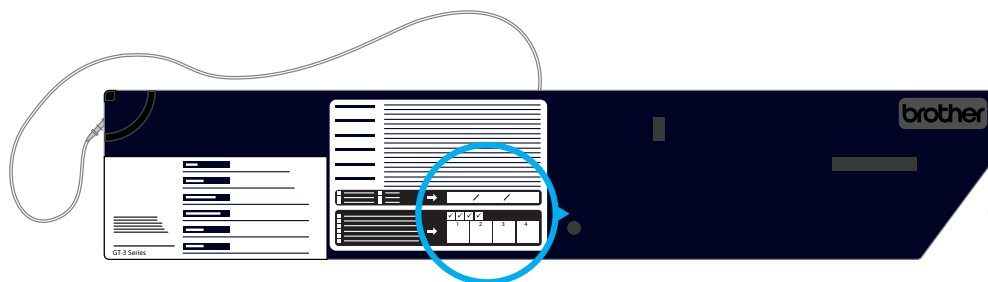

! TO BE USED for *QUARTERLY* MAINTENANCE

This **Maintenance Cartridge for CMYK** should be used to perform the **CTC** every **three months**. It is the only way **to clean** easily all the little **color tubes inside** the Maintenance station and keep a good suction of the pump to clean PrintHeads.

> *It is also a consumable like the MNT Cartridge for White. Mark the date or check the 5L bottles.*



SPARE PARTS NUMBER: **SB3265401**



> NEVER CHANGE MACHINE MODE TO 341 MODE WHEN WHITE HEADS ARE IN THE MACHINE!
Before changing modes please call Technical Support for the explanation and procedure needed to run the machine in this mode and how it may impact the white print heads.

For help, visit [BrotherDTG.com/Support](https://www.brotherdtg.com/Support)



For support videos, visit <https://vimeo.com/brotherdtg>

For ordering parts, visit the Partner Portal www.BrotherDTG.com/Supplies

Part numbers subject to change. If you cannot locate a part on the Partner Portal, call 855-862-1148 and reference your old part number for assistance.

1. ENVIRONMENTAL CONDITIONS	P 1
2. OVERVIEW OF GT3 MAINTENANCE	P 1
3. FIRST BASIC STEPS	P 1
4. HOW TO CREATE A LOG FILE	P 1
5. DAILY MAINTENANCE	P 2
6. WEEKLY MAINTENANCE	P 3
7. ADDITIONAL WEEKLY MAINTENANCE	P 4
8. STANDARD MAINTENANCE SCHEDULE	P 5
9. MAINTENANCE WITH WHITE AGITATION SCHEDULE	P 5
10. ADVANCED MAINTENANCE	P 6
11. CARRIAGE SHAFT CLEANING & GREASING	P 6
12. CARRIAGE RAIL CLEANING	P 6
13. MAINTENANCE PARTS EXCHANGE	P 7 + P 8
14. HOW TO CLEAN PRINthead NOZZLES	P 9
15. HOW TO CLEAN ENCODER STRIP	P 9
16. INK STORAGE RECOMMENDATIONS	P 10
17. NEW SUPPLY MAINTENANCE KITS AVAILABLE FOR GT3	P 10
18. MAINTENANCE PARTS INCLUDED IN CARTRIDGES	P 10
19. OTHER USEFUL SPARE PARTS AVAILABLE	P 11+ 12
20. 341 MODE	P 13
22. CALENDAR FOR BROTHER GT3 SERIES PRINTERS MAINTENANCE	
23. INK, PRETREAT & CLEANING SOLUTION	

> Calendar for Brother GT3 Series printers maintenance

MONTH			
	January	April	July
	February	May	August
	March	June	September
			October
			November
			December

YEAR			
	2022		2025
	2023		2026
	2024		2027

DATES:	1	2	3	4	5	6	7	8	9	10	11	12	13	14	15	16	17	18	19	20	21	22	23	24	25	26	27	28	29	30	31
WEEKENDS:																															
White Tube Flush:																															
White Agitation:																															
White Tube Cleaning:																															
Load White:																															
Shaft Cleaning & Greas.:																															
Mainten. Parts Exch.:																															
Caps Cleaning:																															
Wiper Cleaning:																															
Rail Cleaning :																															
Encoder Cleaning:																															
Color Tube Cleaning:																															

Check the maintenance manual for full details !

DAILY MAINTENANCE

+ Shaking White Ink

If  or  White Agitation

If **not**  or  White Tube Flush

WEEKLY MAINTENANCE

+ White Tube Cleaning

+ Rubber Caps Cleaning

+ Wiper Blade Cleaning

ADVANCED MAINTENANCE

+ CR Shaft Cleaning

+ CR Rail Cleaning

+ Visual Checking

QUARTERLY MNT

+ Color Tube Cleaning

+ Visual Checking

+ Maintenance Parts Exchange when prompted !

INK & LIQUIDS

	Product Description	Product Code
Ink Cartridges	Ink Cartridge (Yellow) 380 cc	BGC3000Y3810002
	Ink Cartridge (Magenta) 380 cc (Cleaning Cartridge)	BGC3000M3811002
	Ink Cartridge (Cyan) Ink 380 cc (Cleaning Cartridge)	BGC3000C3811002
	Ink Cartridge (Black) Ink 380 cc	BGC3000K3810002
	GT3 CMYK Ink (5 of each color)	GT3IKCMYK20P
	White Ink 380 cc (2 cartridges) (Cleaning Cartridge)	BGC3000W3811022
	White Ink 380 cc (2 cartridges per box) 5 Boxes	BGC3000W381102C
	White Ink 380 cc (2 cartridges per box) 20 Boxes	GT3IKWH20PK
Liquids	Pre-Treatment solution (20kg) Sold by weight	BGC300AP2010004
	Pre-Treatment solution (5kg) Sold by weight	BGC300AP5K10002
	GT PreTreat200KG Drum (order qty is 2)	BGC3000P2H10004
	Maintenance solution tank (5L)	BGC5000S5K10002